

CANTERBURY CENTER
205 Dental Drive
Warner Robins, GA 31088



Summary

Area Info

Site Plan

Aerial

Site Map



LEASE PRICE: \$900/Month Modified Gross*

CONTACT

Wendy H Pierce, RPA
478-746-9421 Office
478-335-1254 Cell
wpierce@fickling.com



577 Mulberry St, Suite 1100
Macon, GA 31201
478.746.9421 Office
<https://commercial.fickling.com>

This information is from resources deemed to be reliable and is subject to change without notice. No warranties or guarantees for accuracy are made by Fickling and Company.

PROPERTY INFORMATION

BUILDING

Property Address: 205 Dental Drive
Warner Robins, GA 31088

County: Houston

Total Size: 12,600 SF

Available: Suite 3 – 680 SF
Suite 15 – 680 SF
Suite 16 – 680 SF
(Suites 15 & 16 can be combined)

Utilities: All Available

Parking: Paved, 60 spaces

Traffic Count: 33,100 VPD - Russell Parkway

SITE

Site Size: 0.98 Acres

Parcel ID: 0W054B 051000

Zoning: C-1

Demographics 2024	1 Mile	3 Miles	5 Miles
Population	9,582	59,168	115,412
Avg HH Income	\$83,736	\$87,393	\$95,899
Median Age	35.1	34.9	35.4

LEASE PRICE: \$900/Month Modified Gross*
*Tenant pays Utilities

CONTACT

Wendy H Pierce, RPA
478-746-9421 Office
478-335-1254 Cell
wpierce@fickling.com



577 Mulberry St, Suite 1100
Macon, GA 31201
478.746.9421 Office
<https://commercial.fickling.com>

AREA INFORMATION

PROPERTY

The Canterbury Center has two move-in ready suites available soon! Great tenant mix in the center, including Marchant Law Firm, Epic Health Advisors, Griffin Law Firm, and SetApart Tax & Bookkeeping.

LOCATION

Located on Dental Drive, with easy access to Russell Parkway. Approximately 3 miles from Highway 247 and Robins Air Force Base. Nearby businesses in the area include Planet Fitness, Dollar Tree, Five Star Ford, United States Post Office, and CVS, as well as many restaurants and retail businesses.

CONTACT

Wendy H Pierce, RPA
478-746-9421 Office
478-335-1254 Cell
wpierce@fickling.com



577 Mulberry St, Suite 1100
Macon, GA 31201
478.746.9421 Office
<https://commercial.fickling.com>

Summary

Area Info

Site Plan

Aerial

Site Map

Building I

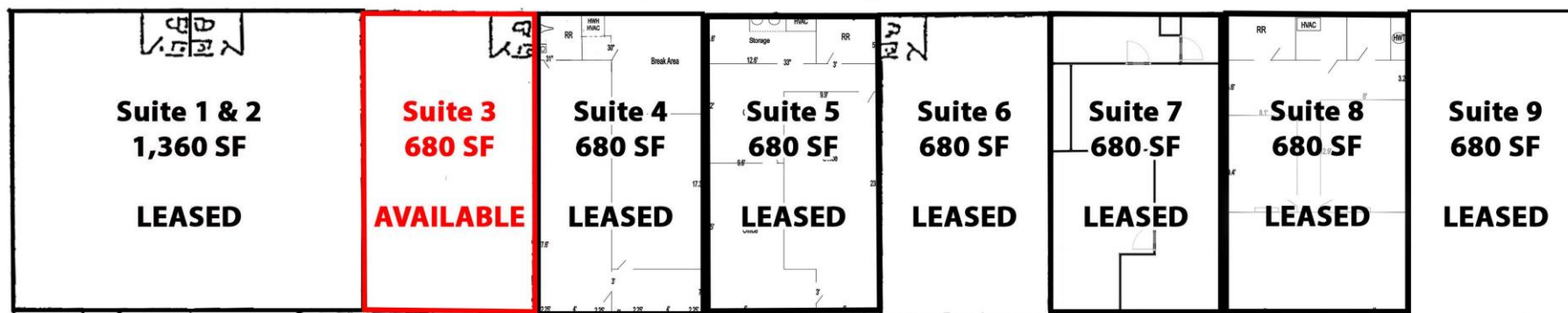

Building II



***Suites 15 & 16 can be combined**

CONTACT

Wendy H Pierce, RPA
478-746-9421 Office
478-335-1254 Cell
wpierce@fickling.com



577 Mulberry St, Suite 1100
Macon, GA 31201
478.746.9421 Office
<https://commercial.fickling.com>

AERIAL



CONTACT

Wendy H Pierce, RPA
478-746-9421 Office
478-335-1254 Cell
wpierce@fickling.com



577 Mulberry St, Suite 1100
Macon, GA 31201
478.746.9421 Office
<https://commercial.fickling.com>

Summary

Area Info

Site Plan

Aerial

Site Map

SITE MAP



CONTACT

Wendy H Pierce, RPA
478-746-9421 Office
478-335-1254 Cell
wpierce@fickling.com



577 Mulberry St, Suite 1100
Macon, GA 31201
478.746.9421 Office
<https://commercial.fickling.com>