



LEASE PRICE:

Suite 7 : \$800/Month Modified Gross* | Suite 18 & 19: \$2,000/Month Modified Gross*

CONTACT

Wendy H Pierce, RPA
478-746-9421 Office
478-335-1254 Cell
wpierce@fickling.com



577 Mulberry St, Suite 1100
Macon, GA 31201
478.746.9421 Office
<https://commercial.fickling.com>

PROPERTY INFORMATION

BUILDING

Property Address:

205 Dental Drive
Warner Robins, GA 31088

County:

Houston

Total Size:

12,600 SF

Available:

Suite 7 – 680 SF
Suite 18 & 19 – 1,360 SF

Utilities:

All Available

Parking:

Paved, 60 spaces

Traffic Count:

33,100 VPD - Russell Parkway

SITE

Site Size:

0.98 Acres

Parcel ID:

0W054B 051000

Zoning:

C-1

Demographics 2024	1 Mile	3 Miles	5 Miles
Population	9,582	59,168	115,412
Avg HH Income	\$83,736	\$87,393	\$95,899
Median Age	35.1	34.9	35.4

LEASE PRICE:

Suite 7 : \$800/Month Modified Gross* | Suite 18 & 19: \$2,000/Month Modified Gross*

*Tenant pays Utilities

CONTACT

Wendy H Pierce, RPA
478-746-9421 Office
478-335-1254 Cell
wpierce@fickling.com



577 Mulberry St, Suite 1100
Macon, GA 31201
478.746.9421 Office
<https://commercial.fickling.com>

AREA INFORMATION

PROPERTY

The Canterbury Center has two suites available! Suite 7 is 680 SF, Suite 18 & 19 is 1,360 SF and comes fully furnished. Great tenant mix in the center, including Marchant Law Firm, Epic Health Advisors, Cornerstones for Life Counseling, and SetApart Tax & Bookkeeping.

LOCATION

Located on Dental Drive, with easy access to Russell Parkway. Approximately 3 miles from Highway 247 and Robins Air Force Base. Nearby businesses in the area include Planet Fitness, Dollar Tree, Five Star Ford, United States Post Office, and CVS, as well as many restaurants and retail businesses.

CONTACT

Wendy H Pierce, RPA
478-746-9421 Office
478-335-1254 Cell
wpierce@fickling.com



577 Mulberry St, Suite 1100
Macon, GA 31201
478.746.9421 Office
<https://commercial.fickling.com>

Building I

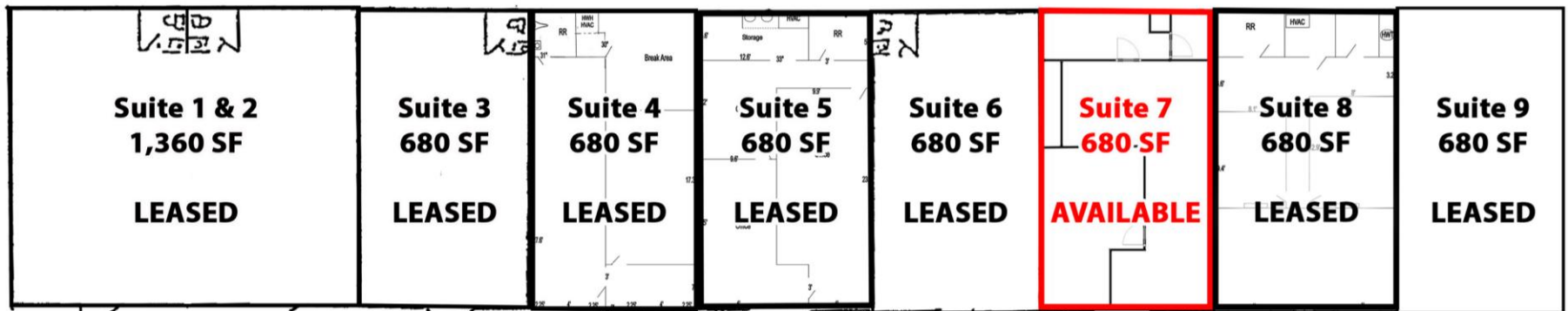

Building II

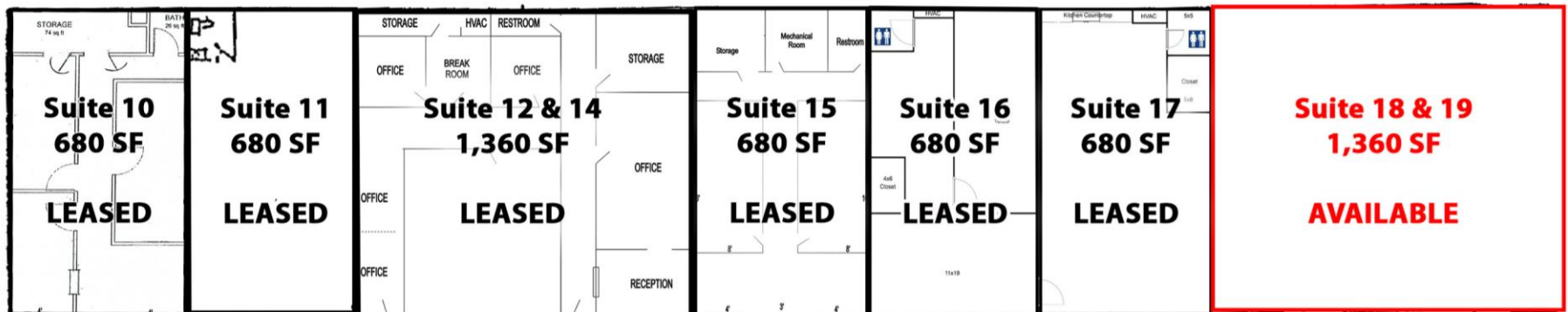

CONTACT

Wendy H Pierce, RPA
478-746-9421 Office
478-335-1254 Cell
wpierce@fickling.com



577 Mulberry St, Suite 1100
Macon, GA 31201
478.746.9421 Office
<https://commercial.fickling.com>

AERIAL



CONTACT

Wendy H Pierce, RPA
478-746-9421 Office
478-335-1254 Cell
wpierce@fickling.com



577 Mulberry St, Suite 1100
Macon, GA 31201
478.746.9421 Office
<https://commercial.fickling.com>

Summary

Area Info

Site Plan

Aerial

Site Map

SITE MAP



CONTACT

Wendy H Pierce, RPA
478-746-9421 Office
478-335-1254 Cell
wpierce@fickling.com



577 Mulberry St, Suite 1100
Macon, GA 31201
478.746.9421 Office
<https://commercial.fickling.com>